

# Technical Information

The below information is to assist in your choice of a suitable Gazco stove. This is not intended to be all the information required to install your stove. This can be obtained from your local Gazco retailer or you can download the full installation instructions at [www.gazco.com](http://www.gazco.com)

## Loft Gas

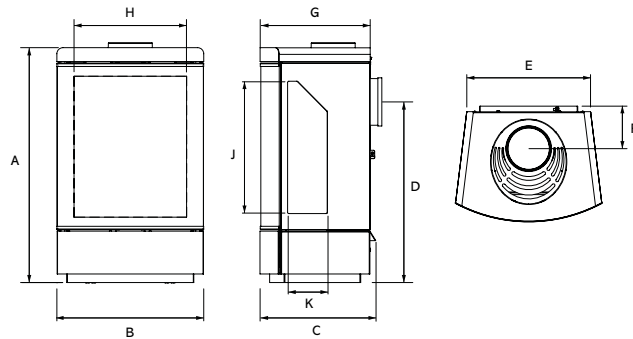

Recommended clearances between stove and other surfaces: top 225mm, sides 200mm, rear must be a minimum of 50mm.

### Dimensions (mm)

	A	B	C	D	E	F	G	H	J	K
<b>Loft</b>	770	481	379	CF:600 / BF:592	406	CF:139 / BF:137	359	369	434	130
<b>Loft with Plinth</b>	815	481	379	CF:646 / BF:638	406	CF:139 / BF:137	359	369	434	130
<b>Loft with Top Section</b>	1412	481	379	CF:600 / BF:592	406	CF:139 / BF:137	359	369	434	130
<b>Loft with Plinth &amp; Top Section</b>	1457	481	379	CF:646 / BF:638	406	CF:139 / BF:137	359	369	434	130
<b>Loft with Log Store</b>	1152	481	379	CF:982 / BF:974	406	CF:139 / BF:137	359	369	434	130
<b>Loft with Log Store &amp; Top Section</b>	1793	481	379	CF:982 / BF:974	406	CF:139 / BF:137	359	369	434	130
<b>Loft Wall Mounted</b>	770	481	399	BF:592	406	BF:137	359	369	434	130
<b>Loft Wall Mounted &amp; Top Section</b>	1412	480	399	BF:592	406	BF:137	359	369	434	130

Product Code	Flue Type	Fuel Type	Heat Input	Heat Output	Efficiency	Energy Efficiency Class	Weight
⊗ 548-006	Conventional	Nat.Gas	6.20kW	4.40kW	78%	D	56kg
⊗ 548-443	Conventional	LPG	5.90kW	4.20kW	78%	D	56kg
⊗ 548-032	Balanced	Nat.Gas	5.30kW	4.50kW	94.3%	A	60kg
⊗ 548-457	Balanced	LPG	4.80kW	4.20kW	94.3%	A	60kg

### Styling Options

948-191	Loft - Wall Mounting Kit
948-016	Loft Plinth - Steel Graphite
948-030	Loft Log Store - Steel Graphite
948-041	Loft Top Section - Steel Graphite
948-077	Loft Plinth - Woodgrain Sandstone
948-102	Loft Plinth - Castillo Sandstone
948-083	Loft Log Store - Woodgrain Sandstone
948-110	Loft Log Store - Castillo Sandstone

**Stove Benches** Loft stoves can also be placed on one of our stove benches. Please see page 78 for further information.

### Accessories

999-620	Remote System Mains Adaptor
8736	Linerless Flue Kit

### Stove Flue Pipe

4500	1' Straight pipe
4501	2' Straight pipe
4502	3' Straight pipe
4514	90° Long 'elbow' adaptor (9" projection)

**Stove Flue Pipe** Balanced flue versions of the Loft must only use the 6" stainless steel flue provided. Gazco recommends the use of 5" matt black enamelled stove pipe with the conventional flue version of the Loft.



Loft with Steel Log Store Base